

567021352\_10 / March 2023 / Subject to technical changes without notice

# Highline coolines

Think holistically:  
Full-length profiles series for all facade elements

More complex building tasks usually have not only high technical, but also an aesthetic demand on facades, windows and other building openings: A homogeneous facade appearance is one of the essential criteria that must be met. With the introduction of the Ecoline S and Highline S sliding doors, Solarlux is complementing its profile family of the same name and thus fulfilling much more than just the demand for a consistent facade design: The holistic approach also eliminates the need for time-consuming and planning-intensive coordination with various suppliers.

#### Ecoline S and Highline S sliding doors

The Ecoline S and Highline S sliding doors are the logical completion of the product portfolio containing the bi-foldings of the same name.

This makes it possible to provide a completely unbroken and uniform profile sight line even in more complex projects. The glass level of the sliding door also fits flush with connected elements such as

windows and bi-folding door, so there is no major offset at the edge of the glass. As the sole system provider and manufacturer of all elements, Solarlux guarantees the highest level of quality not only in technical terms but also in terms of aesthetics, performance, comfort and ease of installation.

#### Uniform profile series

Ecoline bi-folding door

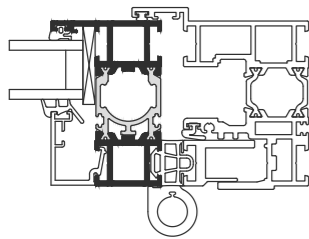

Ecoline S sliding door

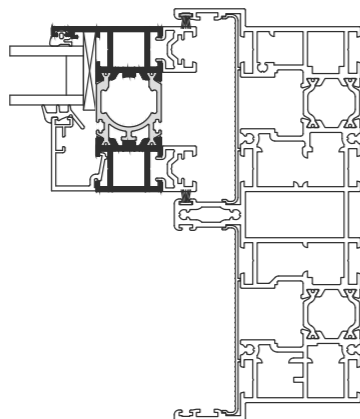

Ecoline window

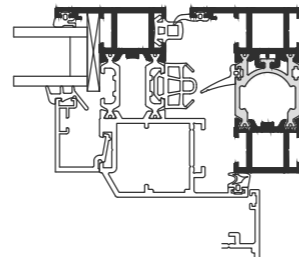

## Expertise for sliding doors: Ecoline S and Highline S

### In-house development with know-how

With the Ecoline S and Highline S, Solarlux will be relying on its own development of sliding doors from 2023. In addition to the same profile series, other proven components from other systems have been deliberately incorporated. For example, both sliding doors make use of components from the bi-folding door family, such as the single-piece, multi-functional fibreglass-reinforced polyamide "bionic TURTLE" break profile or the load-transferring, thermally broken fitting panels.

Through these features, both sliding door systems achieve very good thermal insulation values:

#### **Ecoline S**

28 mm heat-absorbing glass  $U_g = 1.1 \text{ W/m}^2\text{K}$   
(2 x 6 mm float) with warm edge

Solarlux has already proven its expertise in the field of large sliding doors and glass elements with the maximum sliding window cero. So it is only logical that the carriage of the Ecoline S and Highline S comes from the cero family and is therefore more than proven. The new sliding doors thus make use of the best features of systems that have been tried and tested over many years.

#### **Highline S**

50 mm heat-absorbing glass  $U_g = 0.6 \text{ W/m}^2\text{K}$   
(3 x 6 mm float) with warm edge

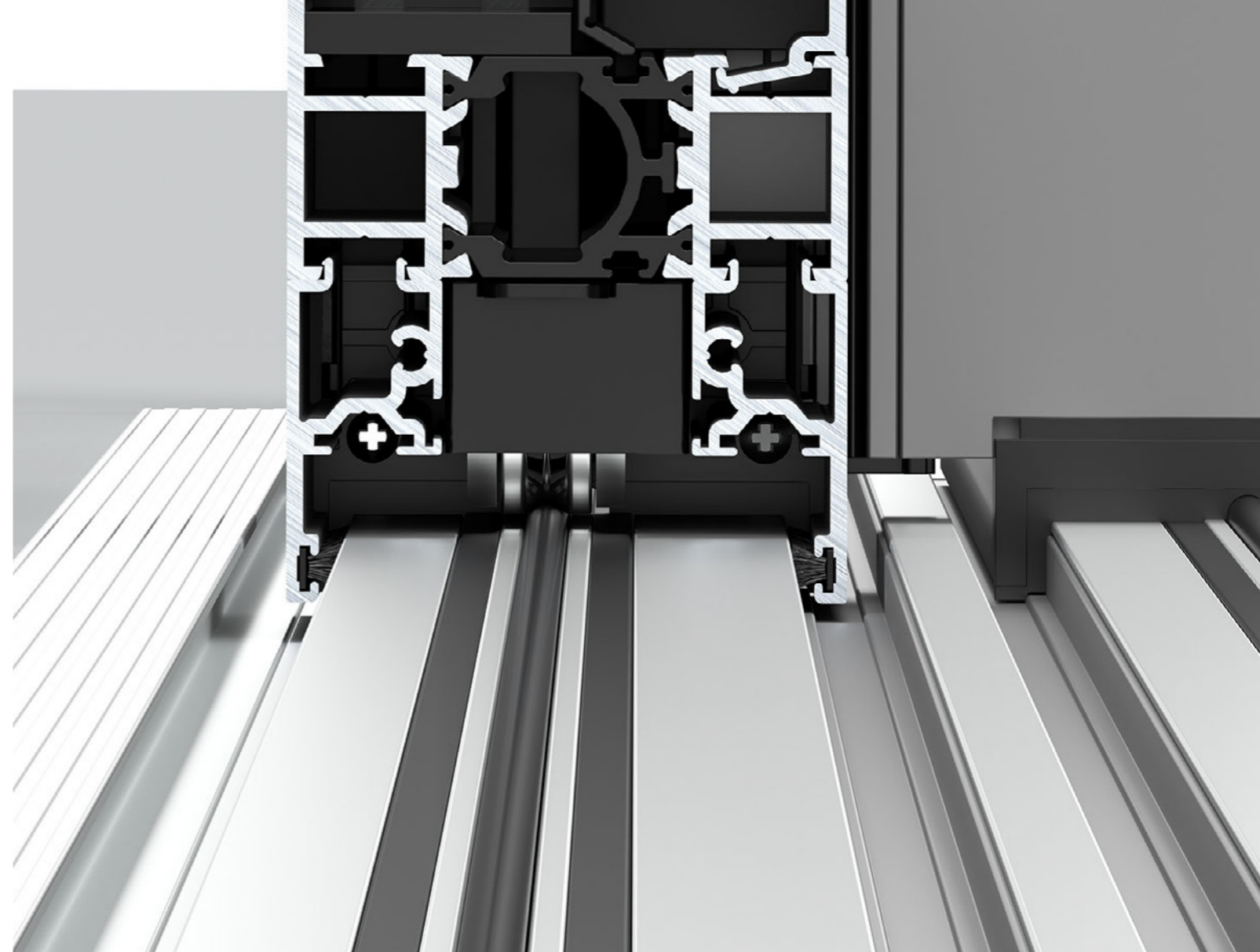

### Effective seal against wind and rain

The horizontal strips under the panel are formed as defined drip edges. The horizontal brush seals are located on the inside of each strip thus ensuring an optimum seal against the floor track.

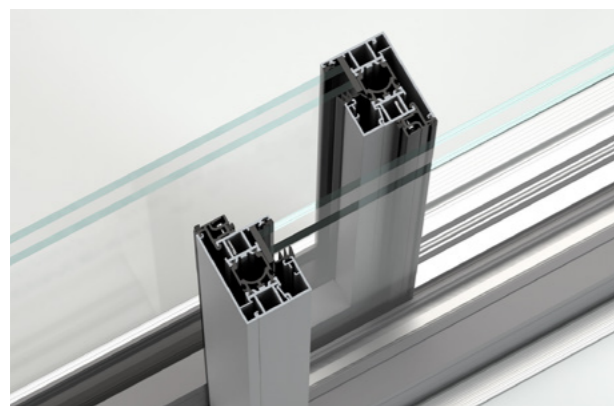

### Concealed screw connections of the forend seals

Both sliding door systems offer an edged profiling with a slim sight line of just 55 mm in the panel butt joint. The vertical seals are attached on the floating mullions without visible screw attachment, the screw channel is concealed by a plastic cover with a jointed edge.

### The track rollers - low-maintenance and non-wearing

The smooth-running, waisted stainless steel rollers run on a shape-optimised stainless steel rail with the cero family's tried-and-tested carriage, enabling optimum load transfer particularly with high panel weights. The centric guidance of the sliding panel additionally reduces the frictional forces, so that

low-maintenance and non-wearing operation is guaranteed even in continuous operation. The carriages have also passed a salt spray test in accordance with DIN EN IOS 9227 and can be replaced at a later date if required.

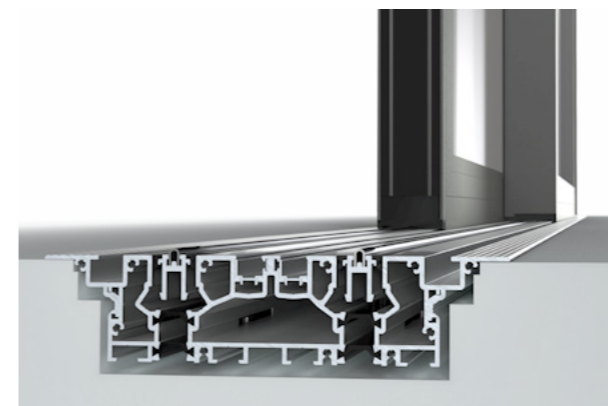

### Accessible floor track with different joint profiles

Both the Ecoline and Highline sliding doors offer an accessible floor track with built-in, cascading system drainage. Future versions will also be optionally available with three different joint profiles (including one with a ramp) guaranteeing effortless adaptation to the existing ground level and an even transition to the floor, thus making them compliant with the German standard DIN 18040 "Accessible building".

One profile family,  
many possibilities

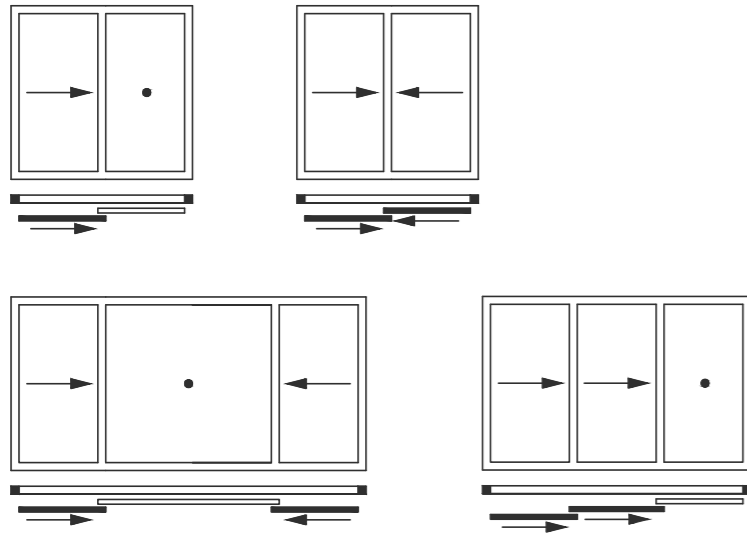

#### Quick check Ecoline S and Highline S

- + Two building depths, Ecoline (67 mm) and Highline (84 mm) for different application areas with differing requirements
- + Ecoline: Panel weight: 300 kg, panel width: max. 2,700 mm, frame height: max. 2,500 mm
- + Highline: Panel weight: 400 kg, panel width: max. 3,200 mm, frame height: max. 2,800 mm
- + Slim forend sight line just 55 mm wide
- + Durable stainless steel rollers with the cero family's tried-and-tested carriage and running tracks for ultra-convenient operation thanks to light sliding action
- + Optional attachment drill holes available in side and top of frame, plus load-bearing, thermally broken fitting panels like those used in the bi-folding door family



#### State subsidies for energy-efficient buildings

Wintergardens that are realised in the future with a bi-folding door and/or a sliding door from the Highline profile series can receive subsidies from the Federal Office of Economics and Export Control (BAFA). The federal subsidy for energy-efficient

buildings (BEG) supports both individual measures and residential buildings with up to 15 %, so that the addition of a wintergarden or renovation work with a bi-folding door and/or Highline sliding door offers attractive options.



Ecoline S and Highline S sliding doors are ideal for use not only in the facade but also in wintergardens or in Avails room extensions. In combination with bi-foldings and windows of the same profile series, a homogeneous view is also created here.